



## Driving Directions and campus map for Meridian High School



Main Entrance

To get to our campus here is a map and directions that will help you along your way. The last page shows a layout of the campus.

### Coming from the South (Bellingham Area)

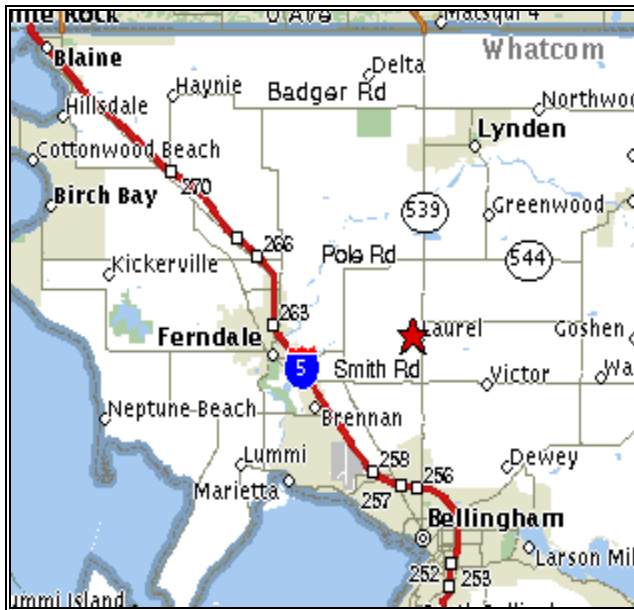

Take the WA-539 N/BELLIS FAIR-MALL PKWY./MERIDIAN ST. (commonly referred to as THE GUIDE) exit- number 256 A-B Keep to the right.

Turn right onto THE GUIDE.

Follow THE GUIDE due north for approximately 5 miles. Turn left (west) onto West Laurel Road this is a traffic light intersection.

Meridian High School will be on the right hand side of the street (north) approximately a quarter mile from the intersection.

*\*see parking info below*

---

### Coming from the Mount Baker Area

Take Mount Baker Highway to E. Smith Road.

Smith Road to Guide Meridian (8.2 miles) – turn RIGHT onto the Guide Meridian.

Guide Meridian to Laurel Road (1.5 miles).

At 4-way stoplight turn LEFT onto W. Laurel Road – drive 0.2 miles to 214 W. Laurel Road – Meridian School District Administration Office

*\*see parking info below*

---

### Coming from Blaine Area

Take I-5 south to Ferndale Exit 262 (12.5 miles)

Turn LEFT onto Main Street – Main Street becomes W. Axton Road.

Take W. Axton Road to guide Meridian (3.4 miles)

Turn LEFT onto guide Meridian

At 4-way stoplight turn LEFT onto W. Laurel Road – drive 0.2 miles to 214 W. Laurel Road – Meridian School District Administration Office

*\*see parking info below*

---

### Coming from Lynden Area

Take Guide Meridian to W. Laurel Road (7.5 miles)

At 4-way stoplight turn LEFT onto W. Laurel Road – drive 0.2 miles to 214 W. Laurel Road – Meridian School District Administration Office

*\*see parking info below*

---

### Parking

Use student parking located directly behind District Administration Office (214 W. Laurel Road – House). High School is 194 W. Laurel Road

From parking area, take walkway to Room 103 – next to Wood Shop. See campus map below

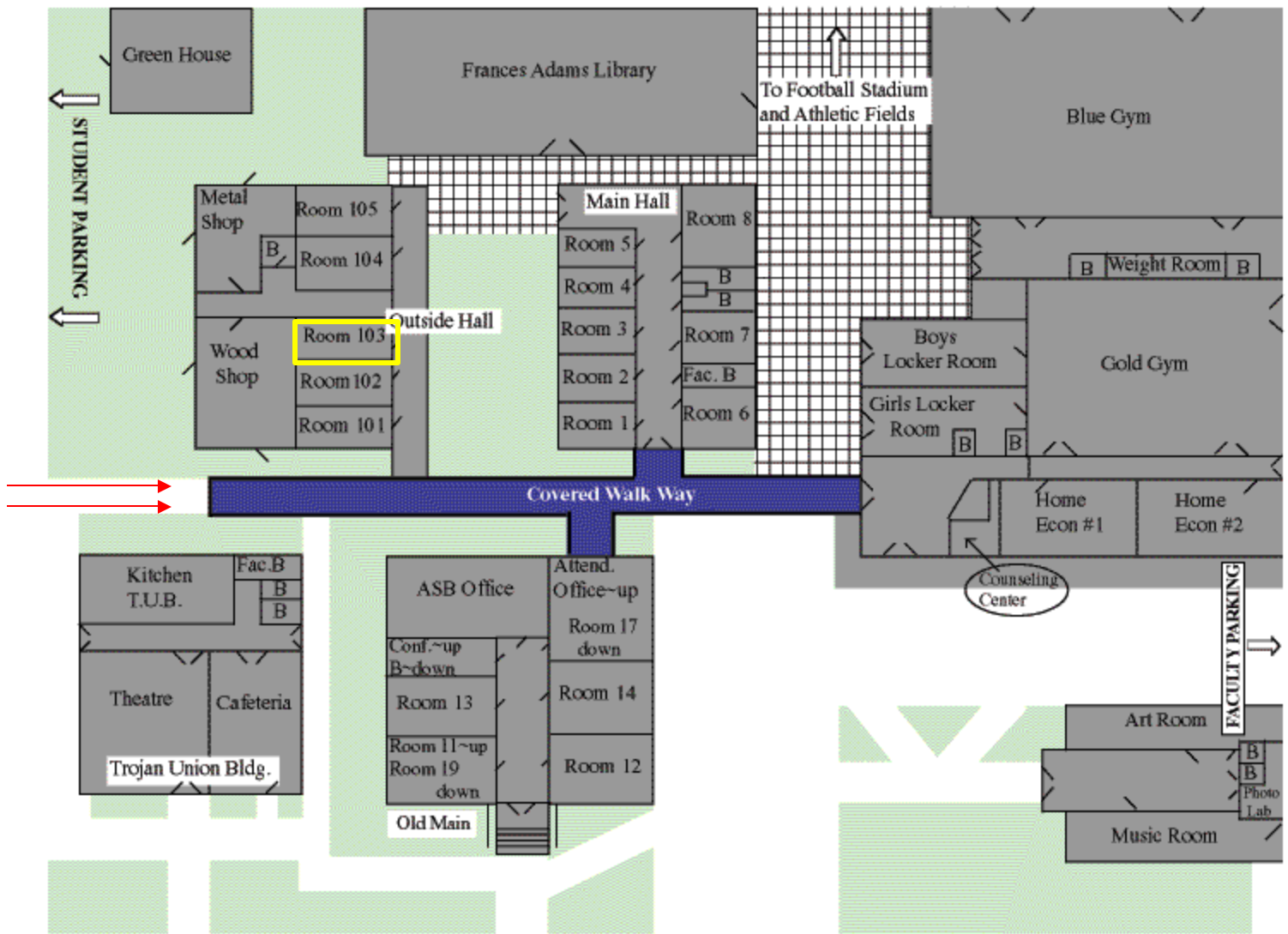

West Laurel Road